

## COMPONENTS

<b>A</b>	STEEL GROUND ANCHOR	x2	
<b>B</b>	BLANKING CAP	x2	
<b>C</b>	'T' BRACKET	x2	
<b>D</b>	STRAIGHT CONNECTOR	x3	
<b>E</b>	LARGE QUICK RELEASE	x6	

## POST SECTIONS

<b>F</b>	CROSSBAR SECTION	x2	
<b>G</b>	UPRIGHT SECTION 865mm LONG - 68mm Diameter	x2	
<b>H</b>	UPRIGHT SECTION 2031mm LONG - 68mm Diameter	x2	
<b>I</b>	UPRIGHT SECTION	x2	

NOTE : All plastic extrusions vary and therefore some tubes may be looser or tighter to connector fittings. If you want to increase the diameter of the fitting just wrap masking tape around the part that fits into the tube, twist as you insert the fitting and it will grab to the tube tight ...you can make tighter fits by adding more tape.

## OPTIONAL ALUMINIUM UPRIGHT POSTS

If you intend to install your posts and leave them in-situ throughout the year we strongly advise to buy the optional aluminium uprights. The uPVC uprights supplied with this goal should not be used in high winds.

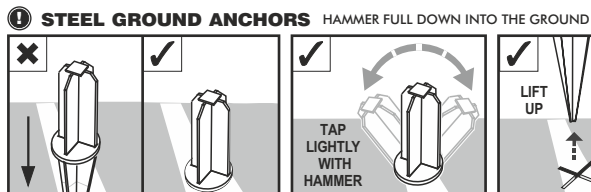

1. Make sure the Steel Ground Anchor is in line square with the posts and hammer fully into the ground.  
2. To remove from ground tap lightly and wiggle left to right and lift up. This should leave the ground undisturbed.

Note : If the ground is hard it is advisable to wet the ground and make a starting hole with a metal pole before hammering the ground anchor into the ground. Damage cause in this way will invalidate your warranty.

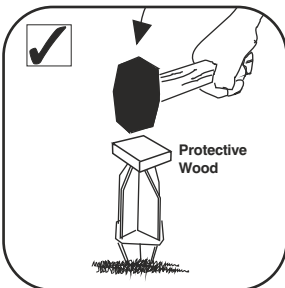

ALWAYS USE A PROTECTIVE PIECE OF WOOD (NOT INCLUDED) BEFORE HAMMERING THE TOP OF THE METAL SPIKE.

This will protect the metal anchor spike and prevent the top becoming misshapen. If the metal spike becomes misshapen this can cause upright posts to split and this would not be covered under the guarantee.

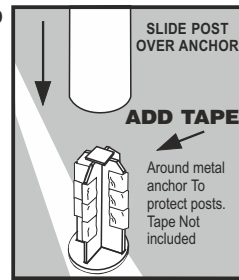
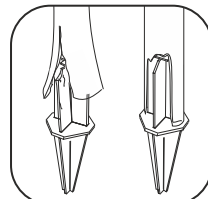

## MINI-RUGBY GOAL - Two section crossbar

1.72m to under crossbar or 2.59m to crossbar  
or for older children 3.75m to under crossbar  
Total post height 4.72m

This rugby post can be assemble to make different sizes of cross bar height to suit different age groups.

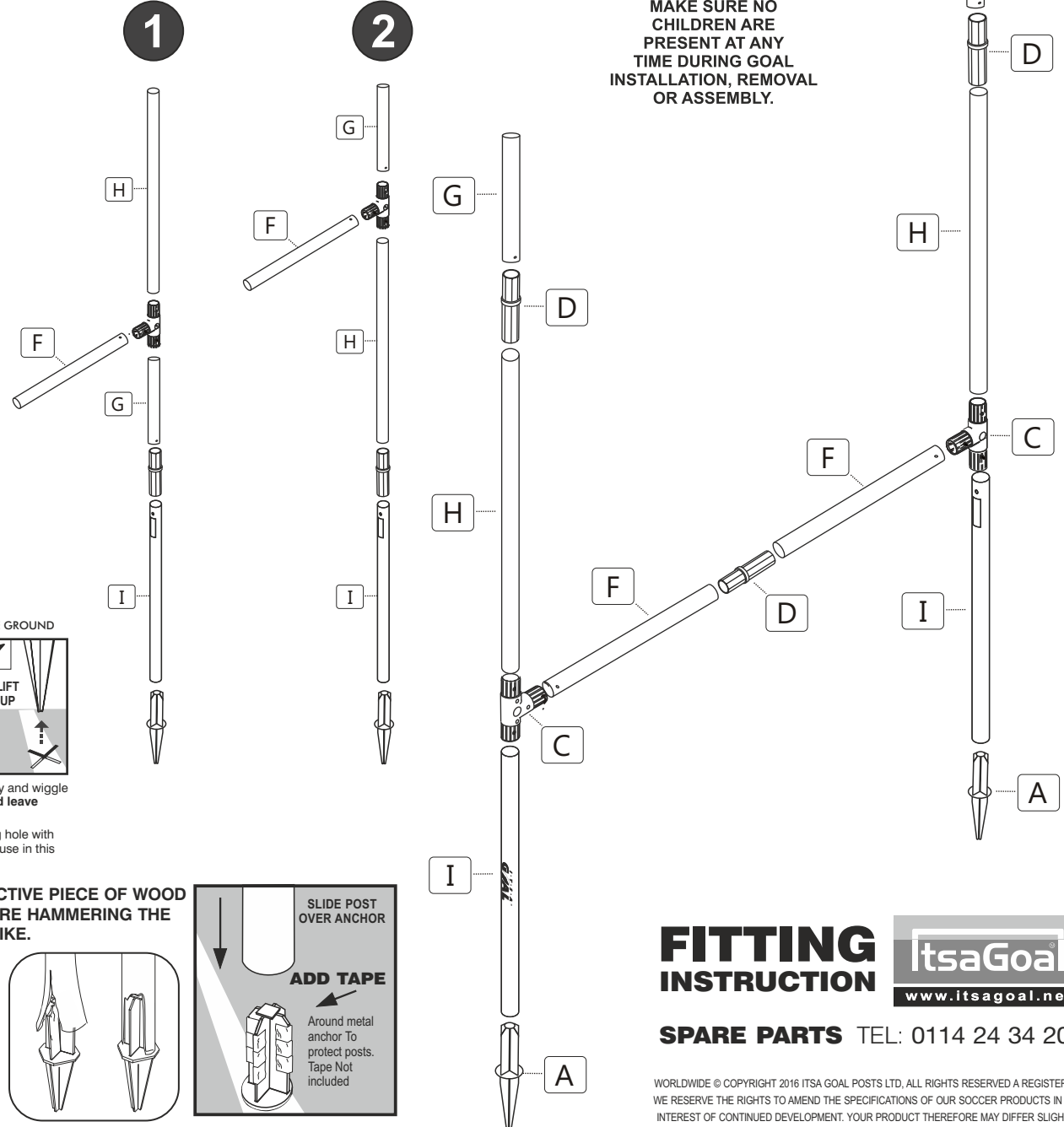

## WARNING

MAKE SURE NO CHILDREN ARE PRESENT AT ANY TIME DURING GOAL INSTALLATION, REMOVAL OR ASSEMBLY.

**FITTING INSTRUCTION**



**SPARE PARTS** TEL: 0114 24 34 200

WORLDWIDE © COPYRIGHT 2016 ITSA GOAL POSTS LTD, ALL RIGHTS RESERVED A REGISTERED. WE RESERVE THE RIGHTS TO AMEND THE SPECIFICATIONS OF OUR SOCCER PRODUCTS IN THE INTEREST OF CONTINUED DEVELOPMENT. YOUR PRODUCT THEREFORE MAY DIFFER SLIGHTLY TO THOSE ILLUSTRATED. E&OE

# 'T' BRACKETS

**!** BEFORE YOU START TO ASSEMBLE YOUR GOAL PREPARE THESE FIRST.

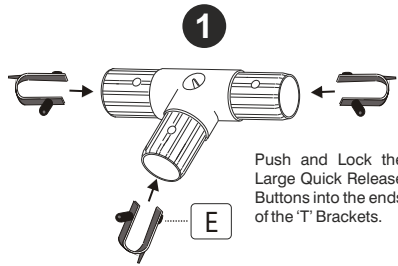

Push and Lock the Large Quick Release Buttons into the ends of the 'T' Brackets.

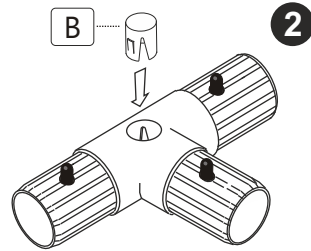

Push and Lock the Blanking Caps in the 'T' Brackets.

### OPTIONAL EXTRA GROUND SOCKET

When the posts are anchored in the same position regularly the ground may become worn. It is possible to concrete ground sockets in position. Concrete the sockets in position following separate ground socket instructions. Pour sand and clay inside the socket. The front ground anchor can be inserted into the clay/sand within the ground socket.

**1** Ground Anchor **2** Sport Surface **3** Concrete Block  
**4** Ground Socket **5** Drainage Hole

**NOTE:** A spacer can be put inside sockets to lift the goal if it is too low or lopsided.

### FRONT GROUND ANCHOR POSITIONS

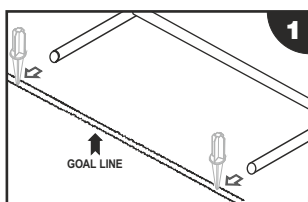

Lay the Crossbar Section along the goal line to give you the correct position to insert the Steel Ground Anchors and the distance between them (steps 1-2).

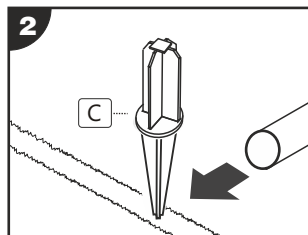

The Steel Ground Anchors need to be sunk into the ground. You will need to hammer the Steel Ground Anchor. Using either a mallet or hammer (step 3).

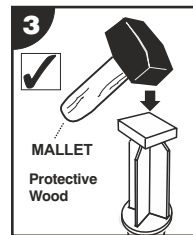

When the Ground Anchor is in position you can now slide the Uprights onto the anchors (step 4).

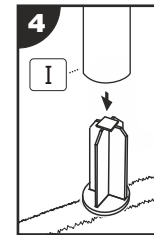

### ! WARNING

**DO NOT SWING ON CROSSBARS.**

CROSSBARS WILL NOT BE REPLACED WITHIN THE GUARANTEE PERIOD IF BROKEN BY SWINGING OR CLIMBING OR ANY OTHER MISUSE.

NOTE: Goal must be anchored otherwise breakages may occur. In extreme conditions it is advised to store away. Do not drop heavy objects on to the plastic tubes.

The posts can be washed with hot soapy water. Any scuff marks on posts can be rubbed off with a light abrasive scouring pad.

**WARNING:** Check the position of any underground services before using the ground anchors and pegs. We take no responsibility for any damage or injury caused in this manner.

NEVER use the goals without the ground anchor system. In severe weather or windy conditions it is advisable to take your goal down as damage is not covered by the guarantee in such circumstances.

It is advisable in any contact sport to take out the relevant insurance's to cover against injury both from taking part, equipment and other unforeseeable circumstances.

Crossbars will not be replaced within the guarantee period if broken by swinging or climbing or any other misuse.

DO NOT try to glue any damaged fixings, plastic materials in this product vary and this may cause the plastic to break. Always replace any damaged components.

### ! WARNING

**DO NOT TOUCH OVERHEAD SERVICES**

DO NOT TOUCH OVERHEAD SERVICES WITH GOALPOST SECTIONS. CHECK THE POSITION OF ANY OVERHEAD SERVICES WHEN SETTING UP OR DISMANTLING THE GOALS, EG. POWER LINES, TELEPHONE CABELS ETC.

We advise adult supervision during assembly and use. Do not use any component parts if they are damaged or broken. Spare parts and replacement nets are readily available.

Hard surfaces: to prevent damage to goal or it's components, loosen soil with a steel pole and moisten with some water before inserting the ground anchors. Do not use the goal in sub zero temperatures. Damaged components requested under guarantee must be returned for inspection. Failure to follow the warnings, fitting instructions contained in this document, may invalidate your guarantee.

The company, its agents and representatives do not accept any product liability if used outside the EU. Use of the product in other countries outside the EU including the USA is not covered and appropriate insurance should be taken out by the user to cover for any eventuality.

We reserve the rights to amend the specifications of our soccer products in the interest of continued development. Your product therefore may differ slightly to those illustrated. Not suitable for children under 36 months until assembled due to small parts.

**SPARE PARTS ARE AVAILABLE**  
**TEL 01142434200**

### ! WARNING CHECK THE POSITION OF ANY UNDERGROUND SERVICES

CHECK THE POSITION OF ANY UNDERGROUND SERVICES BEFORE USING THE GROUND SPIKES AND PEGS. WE TAKE NO RESPONSIBILITY FOR ANY DAMAGE OR INJURY CAUSED IN THIS MANNER. OUR GROUND ANCHOR SYSTEM IS DESIGNED TO GIVE SLIGHTLY UNDER HEAVY IMPACT TO HELP PREVENT SERIOUS INJURY. TO LOOSEN TAP SIDES OF SPIKE WITH HAMMER BEFORE EXTRACTING.