





COMPONENTS

- A** CHROME BARREL LOCK & KEY **x2** 
- B** GROUND SOCKET **x2** 
- B1** SOCKET BOLT 45mm THREAD LENGTH **x2** 
- C** TWIST AND LOCK NET FIXING **x30** 

POST SECTIONS

- F** CROSSBAR SECTION (Elliptical) **x1**
- H** UPRIGHT SECTION (Elliptical) **x2**

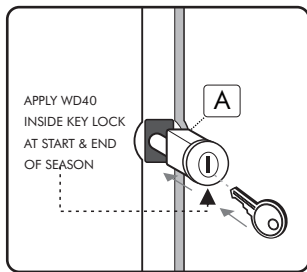

LOCK & SECURE PATENTED SYSTEM

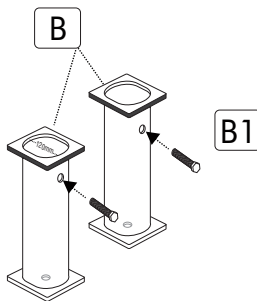

**STADIUM
SOCKETED**

16' X 7' STADIUM ELLIPTICAL SOCKETED GOAL

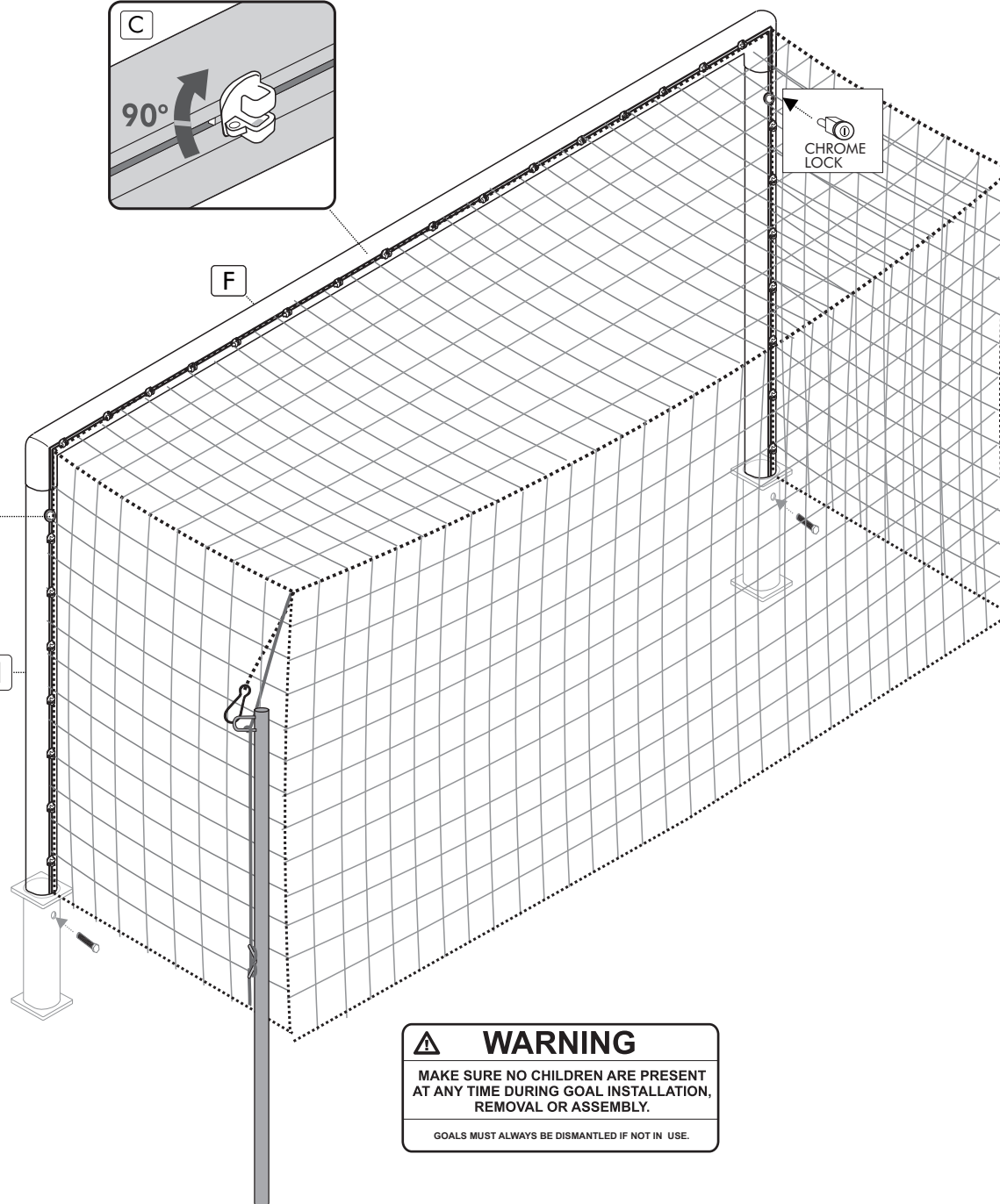
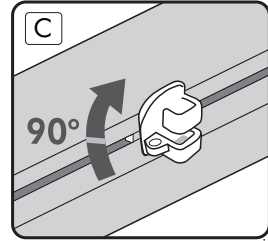

**FITTING
INSTRUCTION**

tsaGoal
www.tsagoal.net

TEL: 0114 24 34 200

CLIP OPTIONAL

OPTIONAL
ITEMS

See the separate
box net fitting
instructions

TENSION
CORD

CLEAT

NET SUPPORT POLE

POLE SOCKET

OPTIONAL

NET SUPPORT



- POL** SUPPORT POLE
Refer to Order for correct TYPE

NET

- NET** GOAL BOX NET
Refer to Order for correct TYPE

x1

SOCKET CAP

- CAP** OVAL LOCKING SOCKET CAP **x2** 
- KEY** HEAVY DUTY OVAL LOCKING SOCKET CAP **x2** 
- KEY** OVAL SOCKET CAP KEY **x1** 

WARNING

MAKE SURE NO CHILDREN ARE PRESENT
AT ANY TIME DURING GOAL INSTALLATION,
REMOVAL OR ASSEMBLY.

GOALS MUST ALWAYS BE DISMANTLED IF NOT IN USE.

GROUND SOCKET *Installation diagram*

- 1 Upright
- 2 Sport Surface
- 3 Concrete Block
- 4 Ground Socket
- 5 Drainage Hole
- 6. Socket Bolt
- 7. Pea Gravel

Note 'Socket bolt' must be inserted to prevent ingress of soil into ground socket. Put a dab of grease on it and insert the screw into the hole and just leave it in place. At any time in the future it can be locked'.

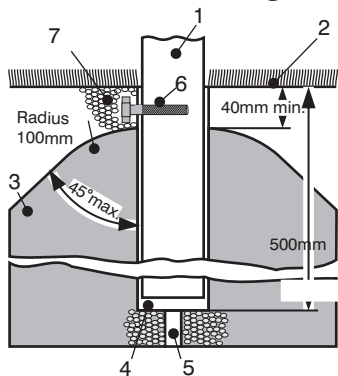

TWIST & LOCK FIXINGS

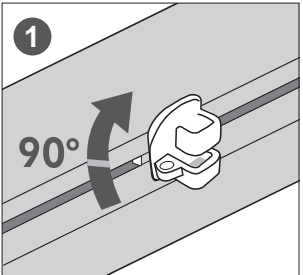

Fit into groove on goalpost section.

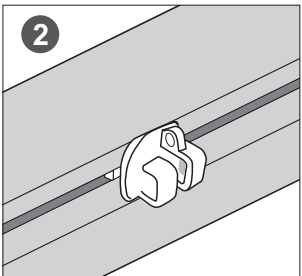

Twist 90 degrees to secure. Position the fixings no more than 340mm apart.

NET FITTING

STEP 1

Attach the net to the twist and lock net fixings on the crossbar and uprights. Fit the corners of the net to the top of each upright first then clip the net onto all other net fixings.

STEP 2

With the steel net support pole laid flat on the floor attach the clip(B) to the end/top of the net support pole. Lift the support pole in the air and insert into the ground socket so that one pole is in place at one end.

STEP 3

With the first steel net support pole(A) in place, repeat this step and fit the middle support pole and then the final end support pole.

STEP 4

All net support poles will be in place now with the net hanging loosely. Now use the tension cord marked to pull the box nets tightly to create a tensioned straight box shape. Pull the cord back and down and wrap in a figure of eight onto the cleat to hold in place. Repeat this step on each pole.

Finally peg your goal net to the ground if the goal is being used on grass or alternatively fit the net to the optional hinged net retainer - see separate fitting instructions.

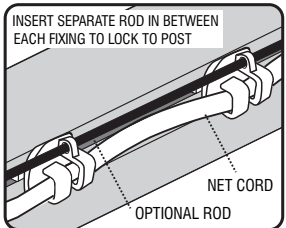

THREAD NET CORD INTO NET FIXINGS

IMPORTANT- GROUND SOCKET

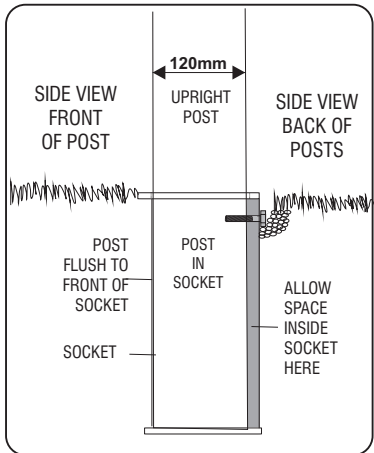

GOAL POST in ground socket side view

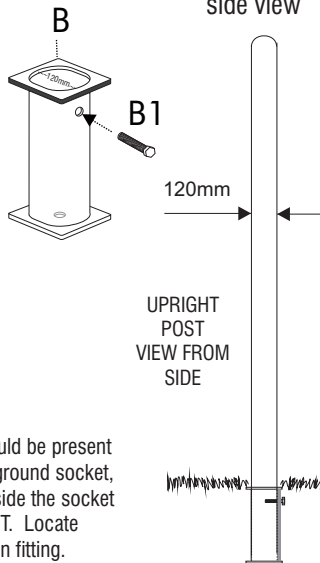

Grey area on diagram denotes the space that should be present once goal is inserted in socket. When fitting any ground socket, tape the top over to prevent concrete dropping inside the socket DURING INSTALLATION OF THE GROUND SOCKET. Locate Upright locking screw to the back of the post when fitting.

GOALPOST PROTECTOR TAPE

AVAILABLE SEPARATELY

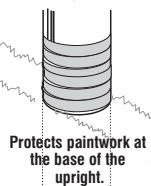

TO PURCHASE VISIT
www.soccertackle.com

LOCKABLE GROUND SOCKET CAPS

ARE AVAILABLE SEPARATELY

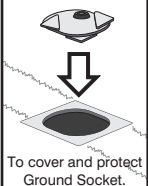

TO PURCHASE VISIT
www.soccertackle.com



For spare parts or additional products call the goal-line
0114 2434200 or visit our online
supplier www.soccertackle.com

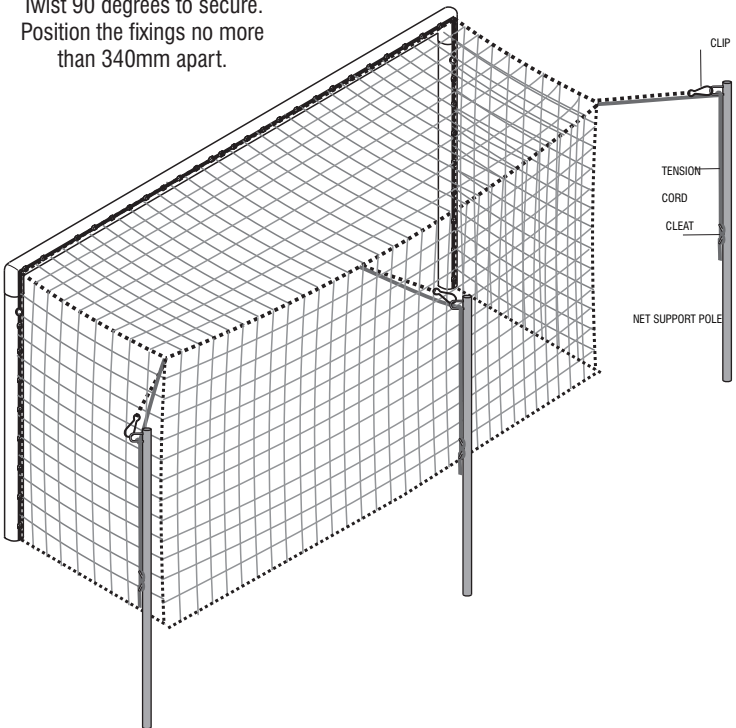

OPTIONAL NET RETAINER

