





COMPONENTS

A	FLANGED CORNER BRACKET with attached FLANGED BUSHES	x2	
B	NYLON SPIGOT	x2	
C	STEEL GROUND ANCHOR 310mm LONG	x2	
D	NYLON REAR GROUND ANCHOR	x2	
E	GROUND PEG	x24	
F	NYLON STANCHION ELBOW	x2	
H	M10 SOCKET DOME SCREW AND HEX DOME NUT - 80mm LONG	x4	
I	M8 HEX SCREW AND HEX DOME NUT - 40mm LONG	x4	
J	ARROW HEAD NET FIXING with attached LOCKING PIN	x24	
AK	HEX KEY FOR COMPONENT J	x1	
NET	GOAL NET 16' x 7'	x1	

POST SECTIONS

Aluminium Sections and Tubes

K	CROSSBAR SECTION 70mm Diameter	x1	
L	UPRIGHT SECTION 70mm Diameter	x2	
M	TOP STANCHION TUBE 40mm Diameter	x2	
N	BACK STANCHION TUBE 40mm Diameter	x2	

GOAL POSTS MUST BE ANCHORED AT ALL TIMES

Optional longer pegs are available for use on sandy ground. On grass, a risk assessment of soil and weather conditions suitability should be carried out when anchors or optional counter weights are to be used. Please note optional guy ropes are available; the guy ropes can be fixed to both sides of the goals to provide extra stability and reduce sideways sway. TEL: 0114 2434200

ALUMINIUM FLAT-PACK

12' X 6' ALUMINIUM FLAT PACK GOAL

(16' x 7' Grass-Surface) - One section crossbar.

FITTING INSTRUCTION

tsaGoal
www.itsagoal.net

SPARE PARTS
TEL: 0114 24 34 200

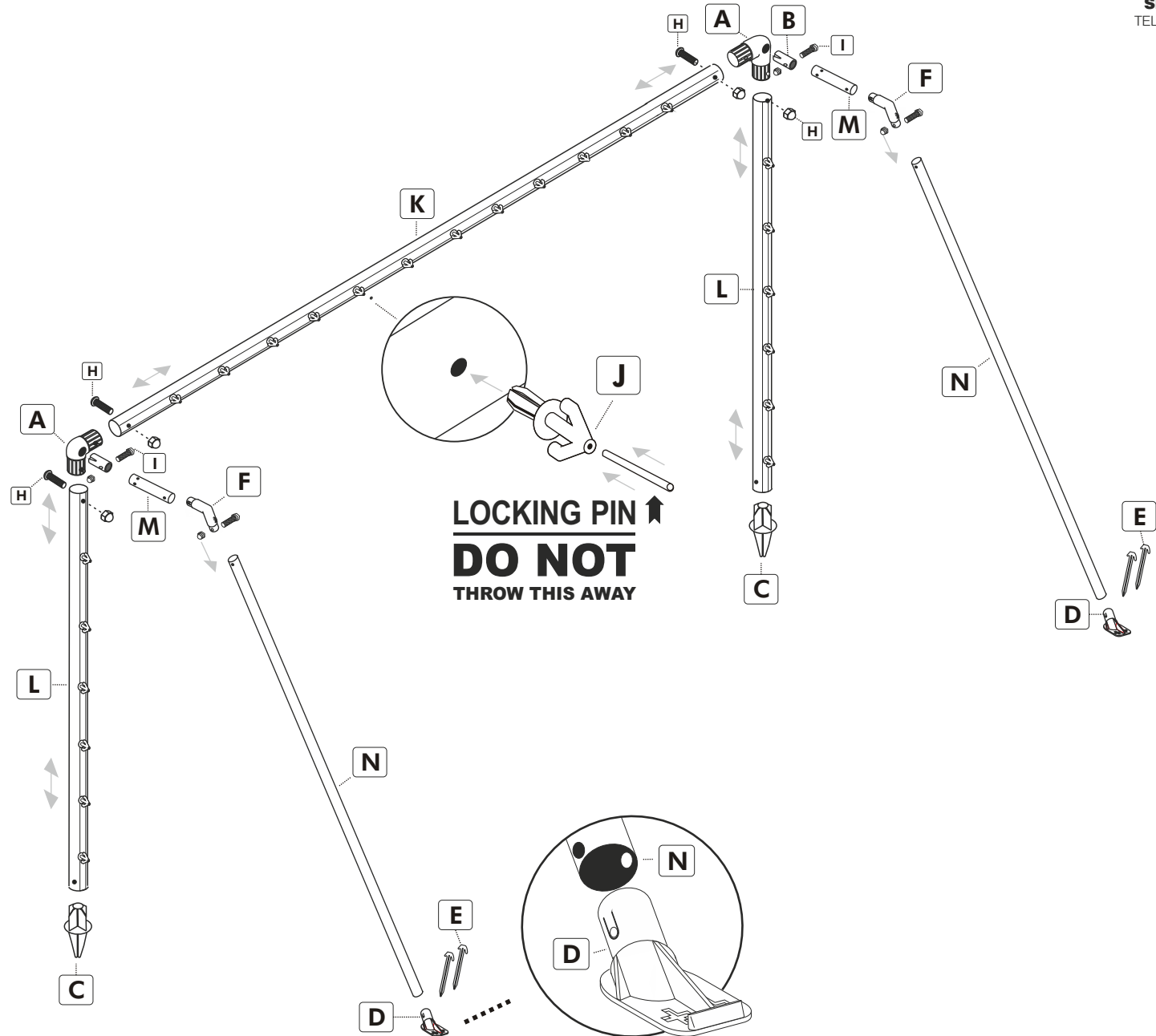

VISIT THE WEB SITE WWW.ITSAGOAL.NET TO REGISTER UK GOALPOST WARRANTY

FRONT GROUND ANCHOR POSITIONS

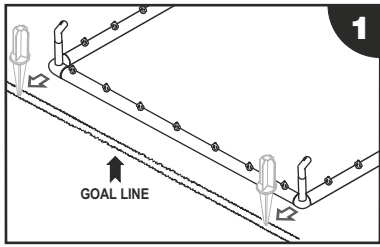

1 Lay the Crossbar Section along the goal line to give you the correct position to insert the Steel Ground Anchors and the distance between them (steps 1-2).

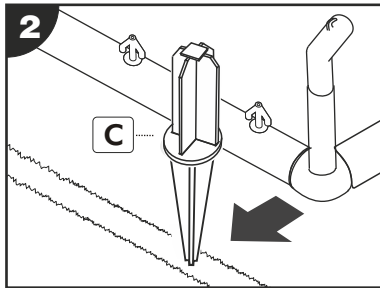

2 The Steel Ground Anchors need to be sunk into the ground. You will need to hammer the Steel Ground Anchor. Using either a mallet or hammer a (step 3).

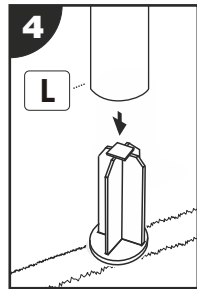
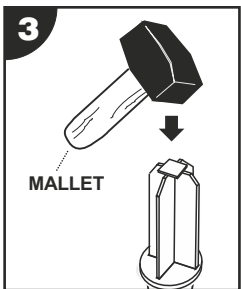

When the Ground Anchor is in position you can now slide the Uprights onto the anchors (step 4).

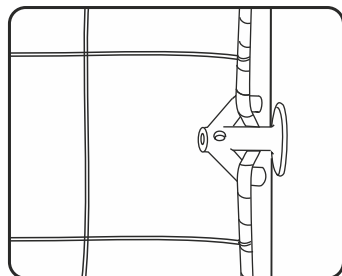

FIT NETS TO ARROWHEAD FIXINGS

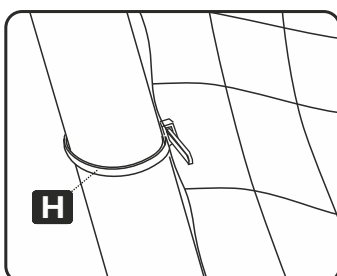

OPTIONAL - STANCHION TIES

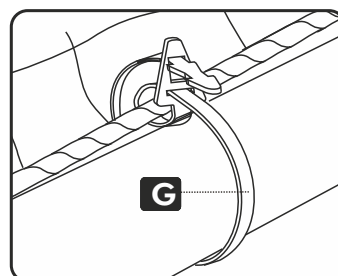

OPTIONAL - NET TIES

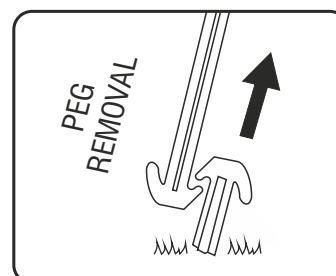

PEG REMOVAL

REMOVABLE NET TIES - OPTIONAL

ENSURE THAT YOU TIGHTEN THE NET TIE AROUND THE NET-CORD (no more than 340mm apart)

Ensure the teeth of the Net tie are facing you (see step 1). Loop the Net Tie around the Net Cord and slide the end into the horizontal slot and pull tight onto Net Cord (see step 1-2).

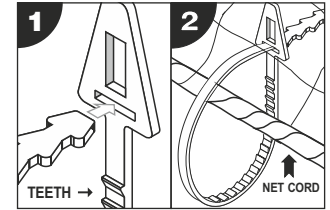

The vertical slot of the Net Tie is used to secure the net to the post. Loop the Net Tie around the post and insert through vertical slot and twist to lock. (steps 3 - 5).

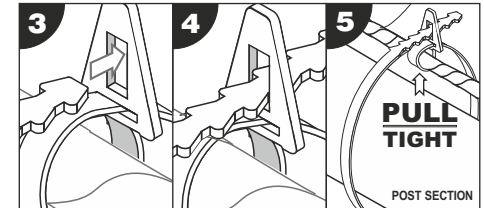

Any excess Net Tie can looped back into the vertical slot. This will also secure the net tie in a fixed position (steps 6 - 8). If Net Ties are to be removed after use then do not loop back into vertical slot.

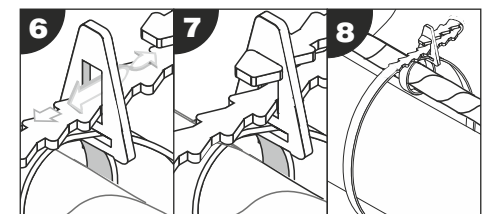

SMALLER STANCHION NET TIES

Smaller net ties are ideal to attach nets to the side frames and the back net support tubes. These are useful when you leave your nets attached to the goals at all times as shown on the diagram to the left. (Diagram A).

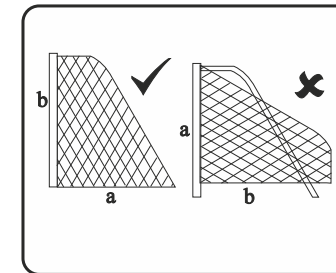

◀ SQUARE MESH Net is cut to shape. Simply throw over the frame and fit each end onto top stanchion by securing on each corner of crossbar.

NOTE: If your net does not fit the first time, you may be fitting it to the goal frame upside down i.e. that is to say the net from the crossbar to the floor (a) is longer than the length of the net to the bottom of the upright. (b)

LONGER GROUND PEGS ARE AVAILABLE SEPARATELY.

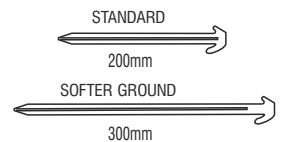

Longer pegs are to be used on sandy or Soft ground earth. A risk assessment of soil conditions suitability should be carried out when anchors are to be used.

DO NOT THROW THE LOCKING PINS AWAY

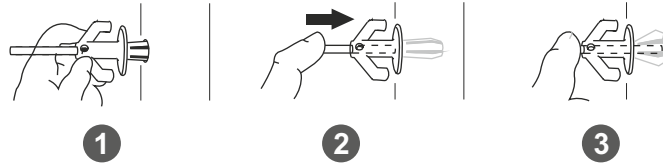

1 Insert Arrow Head into Holes on posts

2 Push locking pin Down centre of Arrow Head

3 Ensure locking pin Is inserted Fully in the posts

CORNER BRACKETS

BEFORE YOU START TO ASSEMBLE YOUR GOAL PREPARE THESE FIRST.

Push and Lock the Spigots to four of the six Corner Brackets.

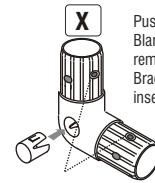
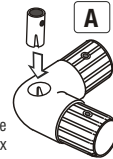

Push and Lock the Blanking Caps to the two remaining Corner Brackets. (already inserted)

Note: small flange bushes are already inserted to create tight fitting bolts.

CORNER BRACKET, STANCHION & ELBOW ASSEMBLY

NOTE: Ensure Top Stanchion holes are aligned with the Stanchion Elbow.

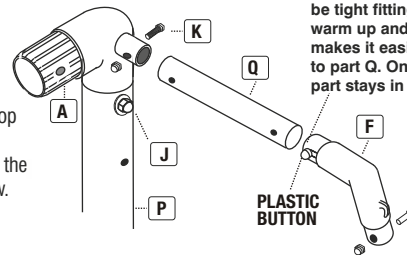

NOTE - The Plastic button on the stanchion elbow is designed to be tight fitting, push in and out to warm up and make pliable. This makes it easier to insert and lock to part Q. Once connected this part stays in place. permanently.