

COMPONENTS

| | | | |
|------------|---|-----|--|
| A | CORNER BRACKET | x2 | |
| B | SPIGOT | x2 | |
| C | FRONT GROUND ANCHOR | x2 | |
| D | REAR GROUND ANCHOR | x2 | |
| E | GROUND PEG | x26 | |
| F | PLASTIC STANCHION ELBOW | x2 | |
| G | LARGE QUICK RELEASE BUTTON | x6 | |
| H | SMALL QUICK RELEASE BUTTON | x4 | |
| I | ARROW HEAD NET FIXING with attached LOCKING PIN | x24 | |
| NET | GOAL NET 12' x 6' | x1 | |

DO NOT THROW THE LOCKING PINS AWAY



POST SECTIONS

| | | | |
|----------|---|----|--|
| J | LEFT CROSSBAR SECTION 68mm Diameter | x1 | |
| K | RIGHT CROSSBAR SECTION 68mm Diameter | x1 | |
| L | UPRIGHT SECTION 68mm Diameter | x2 | |
| M | TOP STANCHION TUBE 40mm Diameter | x2 | |
| N | BACK STANCHION TUBE 40mm Diameter | x2 | |

68mm — 12 x 6 — UPVC ITSA GOAL ANCHORED 2 PC — FI.cdr

12' X 6' UPVC GOAL POST (ANCHORED)

(12' x 6') - One section crossbar.

FITTING INSTRUCTION



CORNER BRACKETS

! BEFORE YOU START TO ASSEMBLE YOUR GOAL PREPARE THESE FIRST.

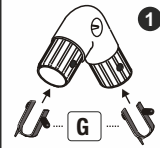

Push and Lock the Large Quick Release Buttons into the ends of the Corner Brackets.

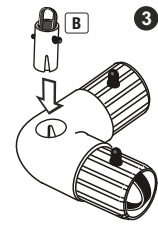

Push and Lock the Spigots into the holes on the Corner Brackets.

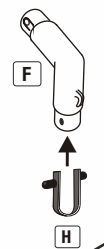

Push and Lock the remaining release buttons to both Stanchion Elbows.

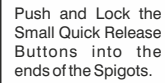

Push and Lock the Small Quick Release Buttons into the ends of the Spigots.

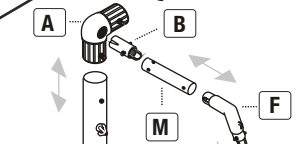

LOCKING PIN
DO NOT
THROW THIS AWAY

IDEAL FOR FIRST TIME ASSEMBLY

NOTE: You can use a furniture polish to make them easier to slot together. Do not grease or use Vaseline

GOALPOST TIP

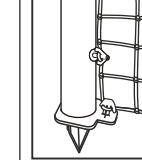

Fit the net to the ground peg at the foot of the post for a better fit.

CORNER BRACKET, STANCHION & ELBOW ASSEMBLY

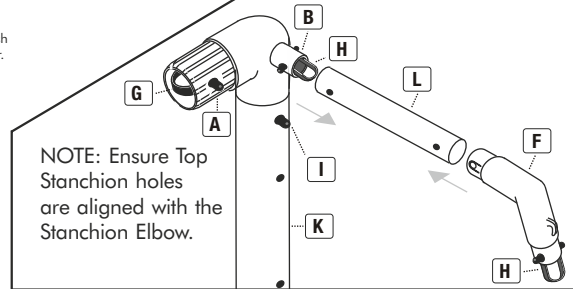

NOTE: Ensure Top Stanchion holes are aligned with the Stanchion Elbow.

! ALL RELEASE BUTTONS MUST BE INSERTED BEFORE ASSEMBLY.

FRONT GROUND ANCHOR POSITIONS

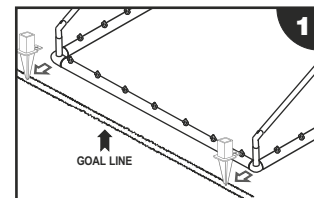

1 Lay the Crossbar Section along the goal line to give you the correct position to insert the Front Ground Anchors and the distance between them (steps 1-2).

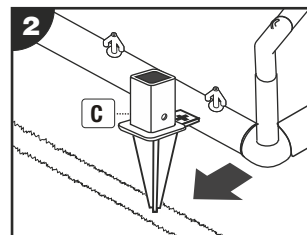

2 The Front Ground Anchors need to be sunk into the ground. For hard grass surfaces you may need to hammer the Front Ground Anchor. Use a wood block to protect the Anchor (step 3).

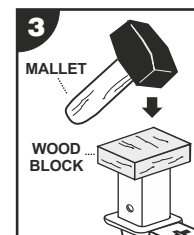

3 When the Ground Anchor is in position you can now slide the Uprights onto the anchors (step 4). To secure the Anchor in the ground use a Ground peg which will keep the Anchor in place (step 5).

